

XMD46-45W STAND

Stand-on Floor scrubber

Operation Instructions



Do not use this device without reading this manual.

Preface

Thank you for choosing our cleaning equipment. We are confident to provide you with this equipment, which is produced through the latest technology and strict quality control.

This manual is designed to help you understand the equipment operation and maintenance, so you can have a more comfortable and efficient product experience. Please read through this manual before using equipment.

Safety Precautions

To ensure the safety of you and your device, please follow these important usage rules!

Do not use this device under the influence of alcohol or medication.

Before any maintenance or repair, please turn off all switches.

This machine must be used by qualified and authorized personnel. Minors and disabled persons are not allowed to use it.

Keep sparks, flames, and smoke away from batteries.

Do not use it in places with dangerous, flammable, or explosive gases, liquids, or steam.

Dress appropriately and do not wear loose clothing or jewelry; keep clothing, gloves, and hair away from moving parts.

Please do not smoke while charging the battery.

In the event of a fire, remember to use a powder fire extinguisher rather than water.

Even when the machine is to be dismantled and scrapped, the process must be watched because some harmful substances (such as batteries, waste oil, etc.) meet the standards and should be sent to a specific center for processing.

Safe Use

1. Before using the equipment, please read this user manual carefully, which will ensure that you are familiar with the control and maintenance requirements of the equipment and help you use the equipment safely.

2. If the machine is used by other people, please be sure to hand over the instruction manual together and tell them to read this manual carefully before using it.

While reading this user manual

This manual covers all configurations of this series of products; therefore, you may find that some of the information does not apply to your device.

All information, specifications and illustrations in this manual will be effective once it is published. Our company reserves the right to change specifications or designs without prior notice.

In this manual, we use () symbol along with the word "Warning" to indicate the existence of a hazard that may result in death or serious personal injury; to avoid or reduce the hazard, the steps must be strictly followed.

In this manual, we use () symbol along with the word "Caution" to indicate the existence of hazards that may cause minor or moderate personal injury or equipment damage; to avoid or reduce the hazard, the steps must be strictly followed.

A mark similar to this () indicates that the arrow points in the direction of the equipment's forward direction.

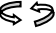
An arrow similar to this () indicates movement or action.

Contents

Chapter 1 Product Introduction	1
1.1 Applicable scenarios	1
1.2 Equipment Overview	1
1.3 Controlling panel and buttons.	2
1.4 List of accessories	2
1.5 Consumables and optional accessories	2
Chapter 2 Installation	3
2.1 Installing the squeegee	3
2.2.1 Squeegee installation	3
2.2.2 suction tube installation	3
2.2.3 Connecting the battery cables.	3
Chapter 3 Inspection and adjustment before use	4
3.1 Inspection	4
3.1.1 Check clean water level	4
3.1.2 Check sewage level	4
3.1.3 Check the battery	4
3.1.4 Check the wear of the brush plate	4
3.1.5 Check the wear of the rubber strips.	4
3.2 Adjustment	5
3.2.1 Adjustment of the squeegee	5
Chapter 4 Operation instructions	5
4.1 Driving	5
4.2 Stand scrubbing mode	5
4.3 Hand push scrubbing mode	5
4.4 Discharging sewage	6
4.5 Shutting down.	6
4.6 Charging	6
Chapter 5 Cleaning and maintenance	7
5.1 Cleaning	7
5.2 Maintenance	7
5.2.1 Replacement and installation of brush plate	7
5.2.2 Replacement and installation of rubber strips	8
5.2.3 Install the squeegee rubber strips.	8
Chapter 6 Transportation and Storage	9
6.1 Transportation	9
6.2 Storage	9
Chapter 7 Common Problems	10
Chapter 8 Technical parameters	11
Warranty Card	11

Chapter 1 Product Introduction

1.1 Applicable scenarios

This equipment can be used in a variety of scenarios, including commercial and industrial places, such as hotels, schools, hospitals, industrial offices, supermarkets, office buildings, etc.; for epoxy floors, PVC floors, terrazzo, wear-resistant floors, tiles and cement floors, wooden floors, rubber floors, different floors can be cleaned with brush plates made of different materials.

1.2 Equipment Overview

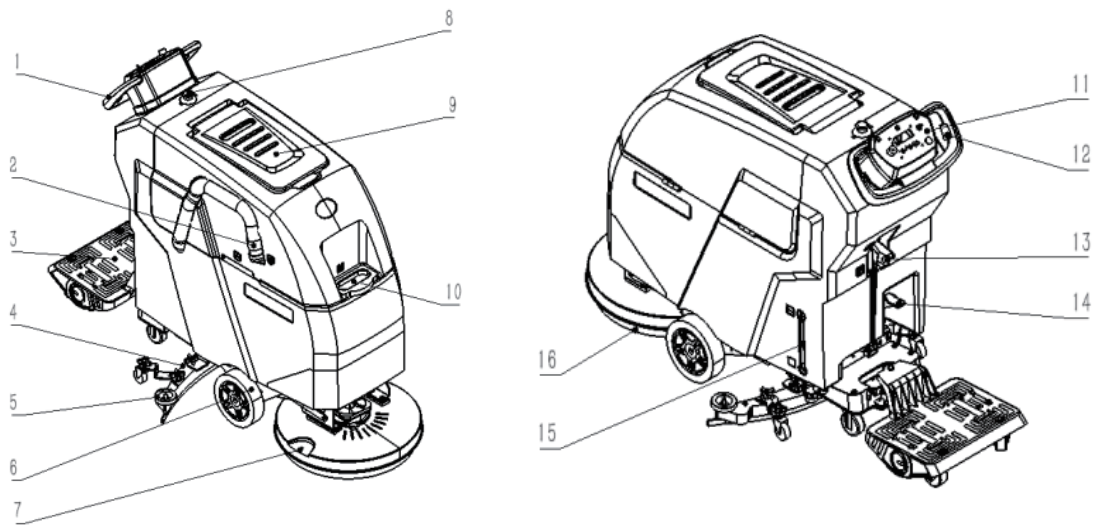

N0.	Name	Function
1	Steering wheel	Control machine's direction
2	Sewage draining tube	Drain sewage
3	Standing platform	For standing to drive the traction board
4	Squeegee	Collect ground sewage
5	Anti-collision wheel	Prevent damage to the machine in the event of a collision
6	Tire	Walking wheel
7	Brush plate anti-collision wheel	Prevent damage to the machine in the event of a collision
8	Emergency button	Emergency power-off button
9	Sewage tank cover	Prevent sewage from splashing
10	Solution tank inlet	Water-adding inlet
11	Central control panel	Machine's control panel
12	Walking switch	Touch switch key
13	Lifting handle	Squeegee lifting and lowering device
14	Brush pedal	Brush plate lifting and lowering device
15	Brush plate	For sweeping the floor
16	Liquid level display tube	Display the current water volume of clean water

1.3 Controlling panel and buttons.

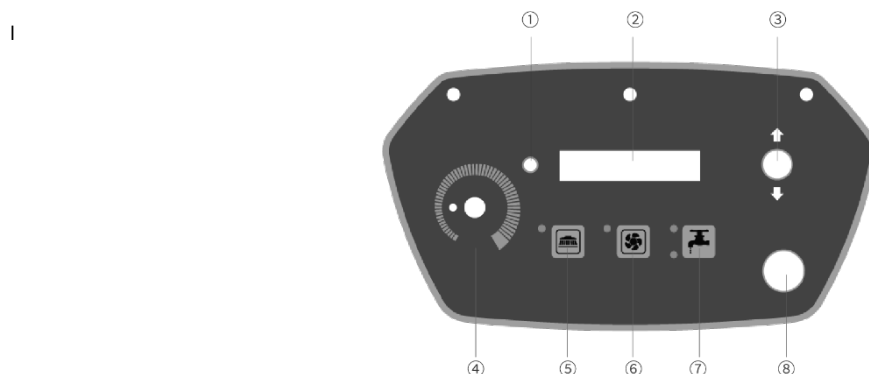

N0.	Name	Function
①	Fault indicator	When the driving axle fails, this light will be on
②	Voltage display meter	Display the battery level and real-time voltage of the device
③	Forward and backward lever	Push the lever forward and the machine will move forward; push the lever backward and the machine will move backward.
④	Speed adjustment knob	Adjust the walking speed
⑤	Brush plate start and stop button	Turn on this switch and the brush plate will rotate to clean the floor
⑥	Suction start and stop button	Turn on this switch and the suction motor starts to work
⑦	Water valve button	Voltage display meter
⑧	Key switch	Turn the machine on/off

1.4 List of accessories

When you open the package, you will find the following components in the package, please check the components listed in the table, if anything missing, please contact us timely.

N0.	Name	Function
①	Host	1
②	Charging cable	1
③	Squeegee assembly	1
④	Tool kit	1
⑤	Operation instructions	1
⑥	Warranty card	1

1.5 Consumables and optional accessories

The consumables for this equipment are listed in the table below, and in case of wear and tear, you need to purchase or replace them.

This device can adapt to different scenarios through different optional accessories, and you can purchase it through suppliers or manufacturers.

Consumables	Optional Accessories	Consumables
Brush plate	Pad holder	Brush plate
Rubber strip	Cleaning pad (red)	Rubber strip
Pad holder	Cleaning pad (black)	Pad holder
Cleaning pad (red)	Cleaning pad (white)	Cleaning pad (red)
Cleaning pad (black)	Lead-acid maintenance-free battery	Cleaning pad (black)
Cleaning pad (white)	/	Cleaning pad (white)

Chapter 2 Installation

2.1 Installing the squeegee

Warning

Please carefully disassemble the outer package to avoid damage to the machine shell.

It is recommended to keep the packaging boxes after receiving the goods so that the machine can be repackaged during later product transportation or return or exchange.

It is prohibited to violently unload the machine to avoid damaging the parts.

Please remove the pallet backwards.

2.2.1 Squeegee installation

Step 1: Pull down the lifting handle of the squeegee and lower the squeegee to the ground.

Step 2: Pass the squeegee fixing screw through the hole of the squeegee and tighten it with plastic knobs.



Step 1



Step 2

2.2.2 suction tube installation

Step 1: Open the recovery tank and insert the sewage suction tube.

Step 2: Insert the tapered end of the tube into the sewage hole of the recovery tank and insert the other



2.2.3 Connecting the battery cables.

Caution

Due to the different distances of logistics routes, to avoid battery loss during long journeys, the battery cables have been disconnected at the factory.

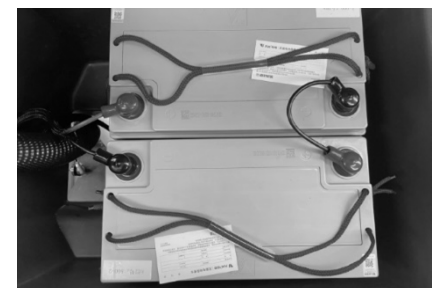

Chapter 3 Inspection and adjustment before use

3.1 Inspection

3.1.1 Check clean water level

⚠ Caution

Please ensure that there is sufficient water and avoid using the suction motor when there is no water. Otherwise, the motor may take in dust. In severe cases, the noise of the suction motor will become louder, or the suction power will be insufficient.



3.1.2 Check sewage level

⚠ Caution

Please pay attention to the water level in the sewage tank. When the white ball in the cage floats, please discharge the sewage in time. If you continue to use it at this time, the suction motor will be short-circuited and burned due to water intrusion.

3.1.3 Check the battery.

After turning on the power switch, the voltmeter will display the battery voltage value. When the voltage is lower than 21V or the last bar is flashing, please charge it first.

⚠ Caution

During the use of the battery, deep discharge will cause the battery capacity to decrease and its life to be shortened. For example: the battery is often used below 21V and is not charged in time.



3.1.4 Check the wear of the brush plate.

Brush plate: When the length of the brush plate is found to reach the red warning line, please replace the brush plate in time. For details, see [Chapter 5 5.2.1 Replacement and Installation of Brush Plate]



3.1.5 Check the wear of the rubber strips.

Rubber strips: Check whether the strips are damaged, deformed, aged, or cracked. If so, please replace them in time. For details, see [Chapter 5, 5.2.2 Replacement and Installation of Rubber Strips].

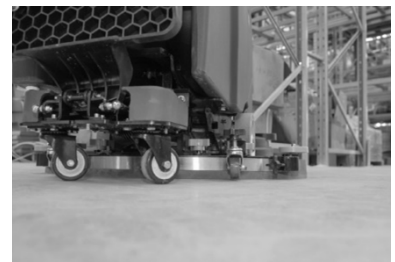

3.2 Adjustment

3.2.1 Adjustment of the squeegee

Adjustment of the squeegee: Turn the nuts on the universal wheel of the squeegee to raise and lower the squeegee slightly. The wheels on both sides need to be adjusted to the same height of that of the squeegee, and the rubber strips must fully touch the ground.

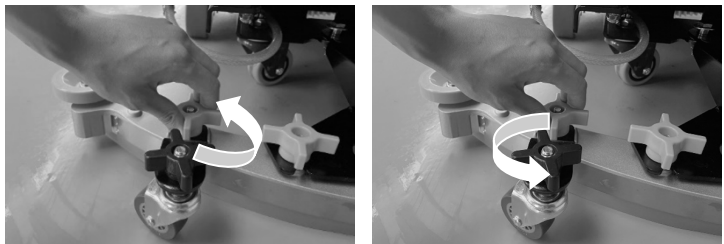

Chapter 4 Operation instructions

4.1 Driving

Turn on the main power key switch of the machine.

Move the forward and backward lever up to the "forward" or down to the "backward" position as needed and hold the walking switch to move the machine forward or backward.

Caution

When the machine needs to be moved backwards or changed places, the brush plate and squeegee should be raised off the ground to avoid wear of the brush plate and deformation of the rubber strips or squeegee sheet metal parts.

When the machine passes through uneven ground or obstacles (like speed bumps), please retract the standing platform, and push it through the obstacle area by hand. It is prohibited to drive while standing.

4.2 Stand scrubbing mode

Step 1: Manually lower the platform.

Step 2: Press down the brush plate lifting foot lever to lower the brush plate to the ground.

Step 3: Move the squeegee lifting handle downward to lower the squeegee to the ground.

Step 4: Turn on the key switch and the water discharge button. Then the solenoid valve in the middle of the brush plate will start to work to discharge water.

Step 5: Turn on the brush plate switch to let it rotate.

Step 6: Turn on the air suction function switch, the suction motor will start to work. Hold the handle and push the machine forward, then you can start cleaning.

Caution

Avoid stopping the machine in the same place for a long time with the brush plate working, as this will leave unnecessary marks on the ground.

4.3 Hand push scrubbing mode

Step 1: Keep the standing platform raised.

Step 2: Press down the brush plate lifting foot lever to lower the brush plate to the ground.

Step 3: Move the squeegee lifting handle downward to lower the squeegee to the ground.

Step 4: Turn on the key switch and the water discharge button. Then the solenoid valve in the middle of the brush plate will start to work to discharge water.

Step 5: Turn on the brush plate switch to let it rotate.

Step 6: Turn on the air suction function switch, the suction motor will start to work. Hold the handle and push the machine forward, then you can start cleaning.

 **Caution**

Avoid stopping the machine in the same place for a long time with the brush plate working, as this will leave unnecessary marks on the ground.

4.4 Discharging sewage

Step 1: Drive the machine to a site that meets the sewage discharge standards, stop the machine, and turn off the power.

Step 2: Remove the sewage tube from the clamp at the rear of the machine, place it downwards, open the tube cover, and discharge the water. The inner wall of the tank can be appropriately rinsed with clean water.



4.5 Shutting down.

When the machine is not in use, empty the recovery tank.

Drive the machine to the parking site.

Turn off all switches on the machine control panel.

Raise the brush plate and squeegee.

 **Caution**

If the machine will not be used for a long time, it is necessary to fully charge it in advance and cut off the battery cable as shown in the figure below to prevent the battery from losing power due to long-term non-use.

4.6 Charging

The correct way to charge battery is to plug in the battery first, then the mains power; after charging, cut off the mains power first, and then the battery plug.

The power system of this floor scrubber is composed of two 12V maintenance-free lead-acid batteries connected in series, and the system voltage is 24V. When the machine has been operating for a period, the battery power will drop. When the last two bars of the power meter are red, or the voltage is lower than 21.6V, it means that the power is insufficient and needs to be charged in time.

When maintaining the battery, please wear protective gloves to avoid contact with acidic substances of the battery.

Check whether the battery connection wire is worn and whether the contacts are loose and replace it if necessary; the battery terminals should be kept clean and dry, without debris and dust covering them, otherwise it will be extremely detrimental to the battery, and in serious cases, it will burn the battery.

To ensure that the battery has a long service life, it should be charged in time after the machine finishes working, but deep discharge is strictly prohibited.

When the machine is not used for a long time, please fully charge the battery, and store the battery with the positive pole (+) disconnected.

 **Caution**

During use of the battery, deep discharge will cause the battery capacity to decrease and its life to be shortened. For example: the battery is often used when the voltage is below 21V and is not charged in time. If the machine will not be used for a long time, it needs to be fully charged in advance, and as shown in the figure below, you should cut off the connecting wires on the battery and wrap them with insulating tape to prevent the battery from losing power due to long-term non-use.

Chapter 5 Cleaning and maintenance

Proper cleaning and maintenance will increase the service life of your machine, so please check and clean the machine regularly!

5.1 Cleaning

Check and clean the wheel set and remove entangled objects.

Clean the sewage tank and sewage tubes regularly and use water to flush the dirt in the tank and blockages in the tubes.

Clean the dirt under the rubber strips regularly and wipe the strips with a cotton rag.

Check the water filter regularly. When there are impurities in the transparent cover, rotate and unscrew the cover, and rinse it and the filter screen repeatedly with clean water.

Caution

The machine is not a tightly waterproof device. Do not flush the machine directly with water in that it may cause a short circuit in your machine or burn out the original electrical components.



Clean the recovery tank.



Clean the rubber strips.



Clean the filter.

5.2 Maintenance

5.2.1 Replacement and installation of brush plate

Step 1: Park the machine on a flat ground, turn off the key switch, and ensure that the machine is in a power-off state.

Step 2: Step on the brush plate lifting pedal to keep the brush plate raised.

Step 3: Grasp the bristles and quickly rotate the brush plate counterclockwise to remove it; when installing the brush plate, make sure the flange is aligned with the brush plate buttonhole, and quickly rotate clockwise to complete the installation.

Caution

There are two types of cleaning pads with different hardness. Choose the more suitable one according to the site.

Replacing the pad holder: The pad holder can be purchased through our company's platform. The specific replacement is to place the cleaning pad at the bottom of the pad holder and make them fit firmly.

The cleaning pad and the pad holder must fit neatly together, then install the pad holder on the machine. The steps are the same as that of the brush plate.



Turn off the power.

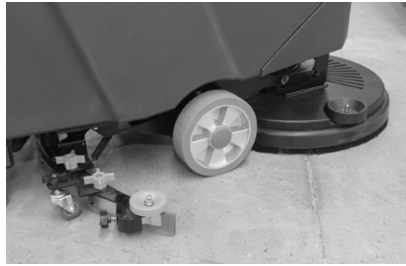

Raise the brush plate.

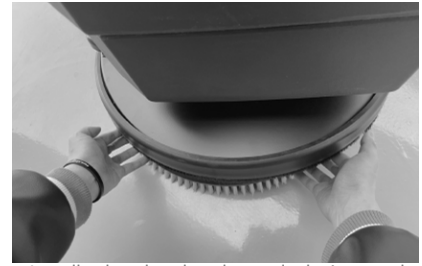

Install the brush plate clockwise and remove the brush plate counterclockwise.

The cleaning pad must be soaked in clean water before using it for the first time for 10-15 minutes. A dry scouring pad will damage the floor.

5.2.2 Replacement and installation of rubber strips

Park the machine on a flat ground, turn off the key switch, and ensure that the machine is in a power-off state.

Lower the squeegee lifting handle, lower the squeegee, rotate the plastic knob in the opposite direction, and take out the squeegee assembly.



Turn off the power.



Lower the squeegee.



Remove the squeegee.

Unscrew the squeegee assembly nuts, remove the squeegee assembly bottom plate, and remove the front and rear rubber strips.



Step 1



Step 2

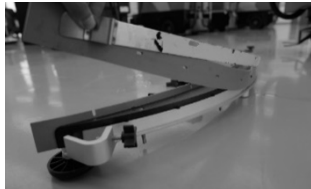

Step 3



Step 4

5.2.3 Install the squeegee rubber strips.

Step 1: Align the holes of the front rubber strip with the protrusions of the plastic component of the squeegee.

Step 2: Fix the plastic component on the bottom plate of the squeegee.

Step 3: Align the holes of the rear rubber strip with the protrusions of the plastic component of the squeegee.

Step 4: Use pressure strips to press both ends.

Step 5: tighten the nuts.

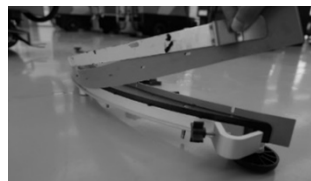
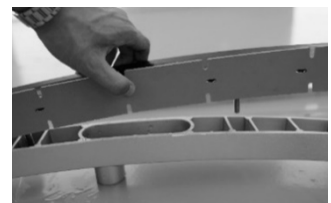

Chapter 6 Transportation and Storage

6.1 Transportation

If the machine and corresponding accessories need to be lifted, it is recommended that you put them on a pallet and then lift them up with a forklift. Clean water and sewage must be drained when transporting the machine.

During transportation, to prevent various situations from slipping and damage caused by collisions, it is necessary to ensure that the binding is firm, the center of gravity is stable, and the driving safety is ensured. For the transportation vehicles that are in contact with the surface, the surface should be installed with soft pads or hard cardboard packaging. Load and unload lightly, and it is strictly prohibited to drop, hit, roll, press heavily, or put the machine upside down.

6.2 Storage

Before storing the machine, clean it. For details, see [Chapter 5 5.1 Cleaning].

For machines that will not work in a long time, anti-rust treatment should be done before storage, check the easily corroded parts of the machine, and apply butter.

If the machine will not be used within 15 days, store the machine fully charged in a clean, dry, and away from flammable places.

If the device is not used for a long time, first fully charge the device battery, disconnect the battery connector, and store it at room temperature above 0 degrees. Keep the battery and ask for replenishment once a month.

In areas with lower temperatures, clean water and sewage need to be drained to prevent the water tanks from cracking due to freezing of clean water or sewage.

Chapter 7 Common Problems

Problem	Phenomenon/Part	Troubleshooting method	Solution
Charging failure	Charging failure	If the charger is not connected to the machine, see whether the green light will be on. If the machine is plugged in, the red light is on, and the built-in fan of the charger does not run	Replace the charger
	Charging interface oxidation	Whether there is any obvious oxidation trace on the copper interface	Clean the charging interface oxide
Suction motor not working	Fuse	Check if the fuse is burnt	Replace the fuse
Brush plate motor not working	Fuse	Check if the fuse is burnt	Replace the fuse
Water not coming out	Clean water tube	Whether there is any scale in the transparent tube of the clean water tube	clean water tube
	Filter cover	Whether there is dirt on the filter cover	Clean filter cover
	Solenoid valve	Measure whether the solenoid valve has input voltage	Check the input voltage of the solenoid valve. If it is normal, remove it and clean the blocked part. Replace the solenoid valve if necessary.
Loud noise	Resonance of water absorbing rubber strips and sewage suction port	1. Is there any abnormal sound when the rubber strips are lifted? 2. Is there any obvious vibration in the water absorbing tube?	Adjust the height of the squeegee universal wheel
	Suction motor	1. Is there any abnormal sound when the rubber strips are lifted? 2. Is there still any abnormal sound after the water absorbing tube is pulled out?	Replace the suction motor
Brush plate	Frequent drop	Has the brush plate been lowered to the ground before turning on the switch?	This behavior is an incorrect operation and may easily cause the brush plate buckle to wear. Replace the buckle when necessary.
	Buckle wear	See the brush plate buckle for wear	Replace the brush plate buckle
The machine not sucking water properly	Floating ball cage clogged	Check whether there are two floating balls in the cage	Matters needing attention in daily use
	Tube blocked	Clean the water suction tube	Daily cleaning and maintenance
	Recovery tank sealing circle	Sealing circle aging	Replacement of accessories
	Water marks on the ground	1. Whether the strips are cracked, aged, or deformed 2. Whether the strips are wavy	Replacement of rubber strips
Machine not walking	Solenoid brake	Check whether the solenoid brake is on the downward gear when the machine is not powered on	Contact customer service center
	Accelerator	1. Short-circuit the accelerator connector. If the machine can move, there is something wrong with the accelerator pedal. 2. The fault lamp flashes 7 times.	
	Controller	Use a multimeter to measure whether the controller has input voltage	

Chapter 8 Technical parameters

Category	Wired	Wireless
Cleaning width	500mm	500 mm
Squeegee width	825mm	825 mm
Continuous working time	/	2-3h
Theoretical working efficiency	2800 m ² /h	3300 m ² /h
Battery capacity	/	24V/100Ah
Suction motor power	600W	400W
Brush plate motor power	550W	550W
Driving motor power	/	150W
Clean water capacity	60L	56L
Sewage capacity	55L	60L
Total weight	136kg	150kg
Working size	1200*825*1000mm	1630*800*1110mmm

Warranty Card

Name		Tell	
Postal address		Bill No.	
Purchase time		Number	
Product model		Date	
Replace accessories			
Fault description			

